

✓  
a 57-168  
No 5438

(Portage  
- Potter)

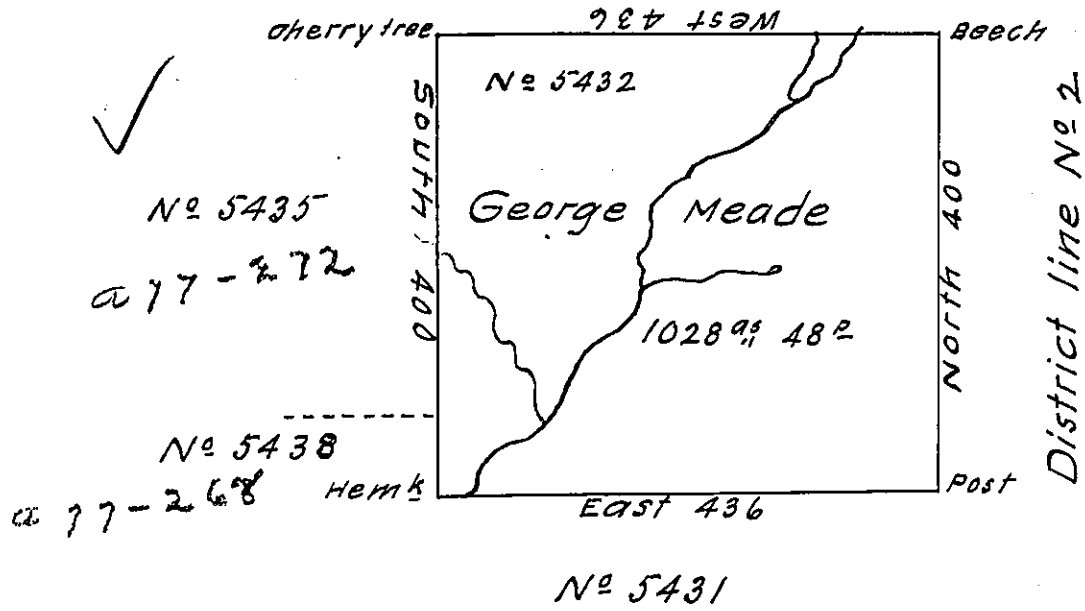

No 5431

a 77-273

✓

Situate on the waters of Sinnemahoning Creek in North<sup>d</sup> County containing 1028 acres 48 perches and the usual allowance for roads. Surveyed May 17<sup>th</sup> 1794 for George Meade in pursuance of a warrant No 5432 dated 3<sup>d</sup> March 1794.

John Canan D. S.

Daniel Brodhead Esq<sup>t</sup> S. G.

IN TESTIMONY that the above is a copy of the original remaining on file in the Department of Internal Affairs of Pennsylvania, made conformably to an Act of Assembly approved the 16th day of February, 1833, I have hereunto set my Hand and caused the Seal of said Department to be affixed at Harrisburg, this Seventh day of February 1912

*Henry Hower*  
Secretary of Internal Affairs.